

Trunk Release Configurations

Positive Trunk Release

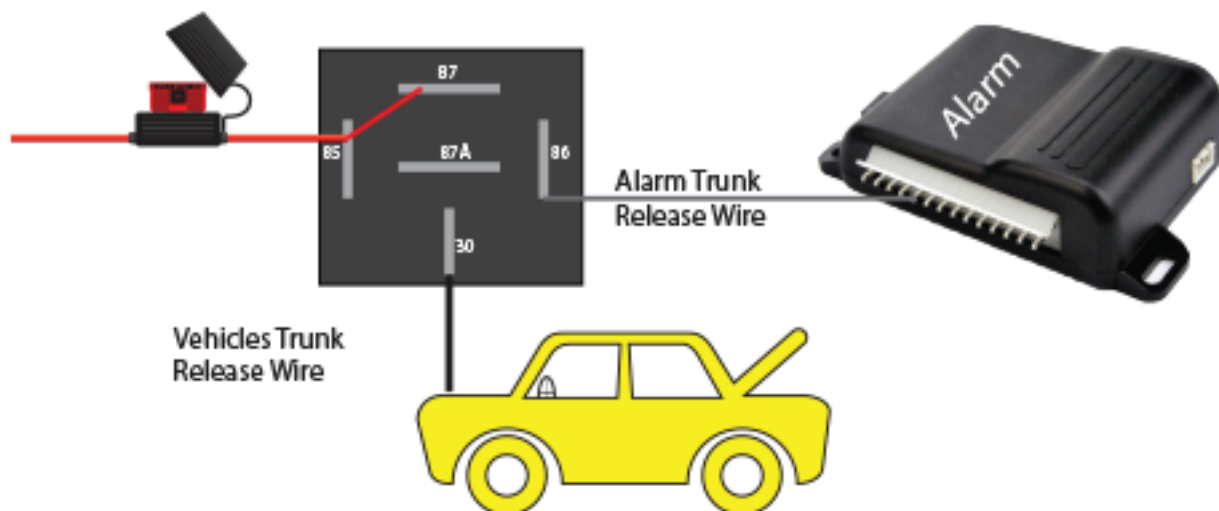

Negative Trunk Release

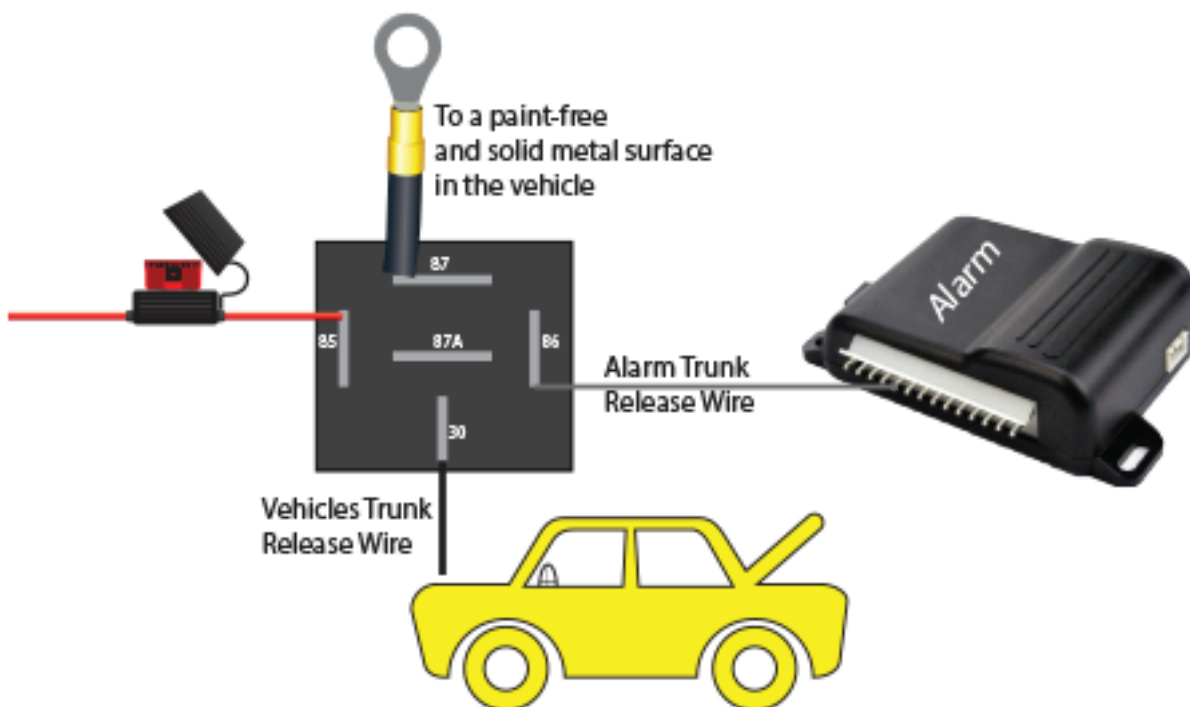

Reverse Polarity Trunk Release

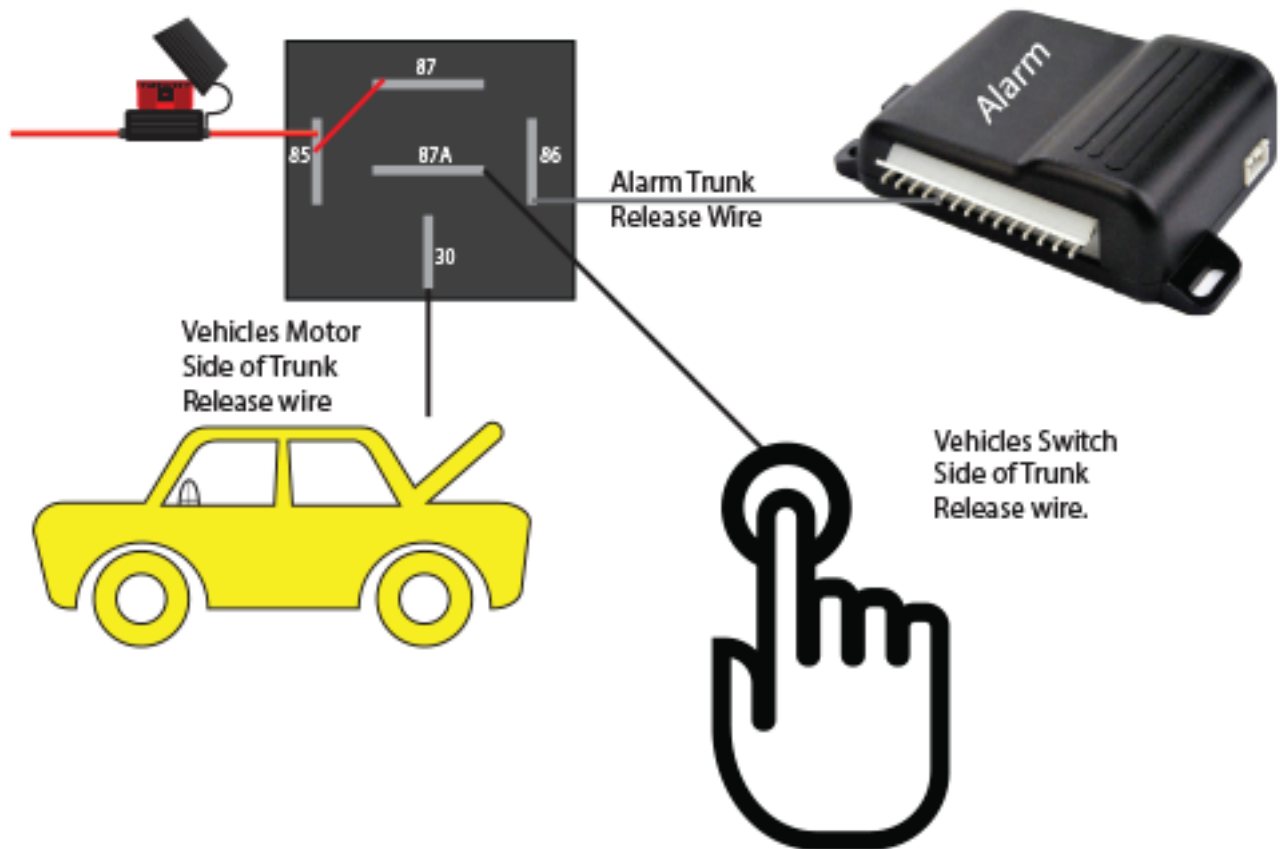

Using a standard 30 Amp automotive SPDT (single poll double throw) relay you will be able to convert a negative output from your alarm or remote start into a positive output. You can also create a stronger negative trunk output by triggering a relay. On vehicles that require reverse polarity to release the trunk, this can be accomplished using the standard 30 Amp SPDT relay. Follow the diagrams for the system that will work for your install.